

CORONADO™

S E R I E S V I N Y L W I N D O W S

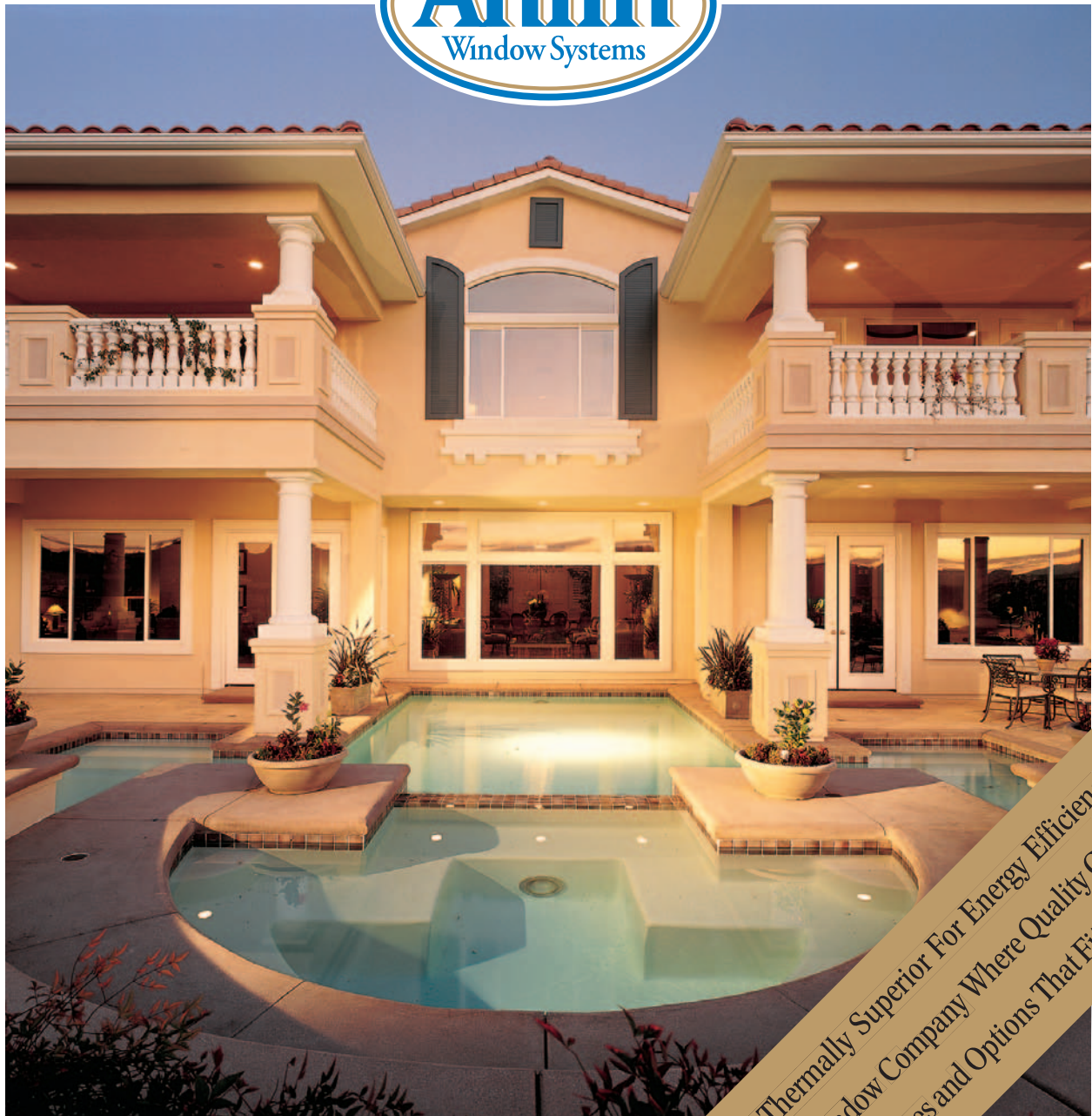

- Thermally Superior For Energy Efficiency
- Use a Window Company Where Quality Comes First
- Get Features and Options That Fit Your Needs

Six Great Reasons to Buy Vinyl

WHY VINYL REPLACEMENT WINDOWS FOR YOUR HOME?

ADD BEAUTY AND VALUE TO YOUR HOME Coronado windows will enhance the beauty of your home and increase its market value. Select from a variety of styles that allow you to personalize the look of your home.



KEEP NOISE OUT & COMFORT IN

Home is where outside clamor should give way to indoor calm. Coronado windows are engineered to reduce exterior noise, making your home a quieter and more comfortable place to live.



Open, Close, and Clean with Ease

Coronado series vinyl windows are easy to use and easy to clean, especially models with tilt-in sashes. A simple wipe-down with soap and water keeps the frames beautiful for life.

Vinyl Replacement Windows



ENDURING CHARM Coronado windows combine the charming, crafted look and energy efficiency of wood frame windows, but with the low maintenance of metal windows. Coronado windows will never rot, peel, or flake like wood frames, nor will they corrode, rust, or pit as metal windows do with age.



Wood windows need constant care because they fade, chip, peel, and crack. Replacement windows from Anlin have color blended right into the vinyl for a lasting finish that's easy to maintain and never needs painting.



REDUCE ENERGY BILLS YEAR ROUND Coronado windows are among the most efficient dual-pane windows ever built. Each of them creates an energy-saving barrier that keeps your home warmer in winter and cooler in summer.



Feel Safe and Secure, Day and Night

At Anlin, home security is a top priority. You can rest easy knowing that our windows—with reinforced, continuous interlocking rails and two locks on larger sizes—have exceeded the toughest forced entry resistance tests in the industry.



Use a Window Company V

WHY CHOOSE ANLIN VINYL WINDOWS?

OUR PEOPLE MAKE THE DIFFERENCE Anlin windows are built by a family of skilled people who take pride in every step of the manufacturing process. Expert design, precision engineering, premium materials and superior workmanship are the cornerstones of every product that bears our name. Our windows reflect the uncompromising standards of the people who build them. At Anlin, nothing less will do.

OUR FULL LIFETIME WARRANTY

SAYS IT ALL Coronado series vinyl windows are guaranteed for as long as you own your home. Your investment is protected by our Full Lifetime Warranty that includes non-prorated coverage, and glass breakage. For details, ask your dealer for the Warranty, or see it on our website.

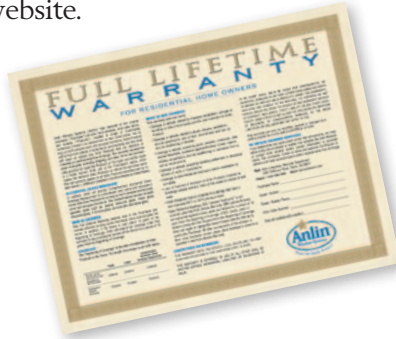

Our insulated glass units are cut with high-speed, close-tolerance machines, then assembled in our insulated care unit.



"Quality windows from our family to yours"



After welding, we remove the excess material with precision equipment for an aesthetically superior finish.

Not All Vinyl is Created Equal

Anlin's vinyl compound is made to exacting standards using state-of-the-art computerized blending and compounding equipment. The resulting vinyl extrusions perform equally well in winter's freezing cold and summer's blazing heat.

Other Vinyl Can Allow Light to Pass Through

When exposed to identical conditions of light intensity, a competing vinyl allows more light to pass through than Coronado vinyl window frames of identical wall thickness. More light means ultraviolet rays can attack the polymer bond, resulting in less protection for your windows and home.

*Other Vinyl:
Too much light
coming through.*

*Coronado Vinyl:
Little light
penetration.*

Anlin Vinyl B... All Light Pen... Coronado s... window pro... with high-gr... dioxide to bl... and provide... screen." Les... more protect... windows an...

See the Light?

Where Quality Comes First



HOW WE BUILD QUALITY WINDOWS

PRECISION MANUFACTURED

Each stage of our manufacturing process incorporates state-of-the-art computer-controlled equipment to achieve precise window specifications. The result is an attractive yet durable window that exceeds industry standards for structural and thermal performance.

DESIGNED RIGHT, BUILT FOR LIFE

Anlin engineers use the most advanced design and manufacturing tools available to create windows with lasting beauty, operation and performance characteristics that meet your every need.

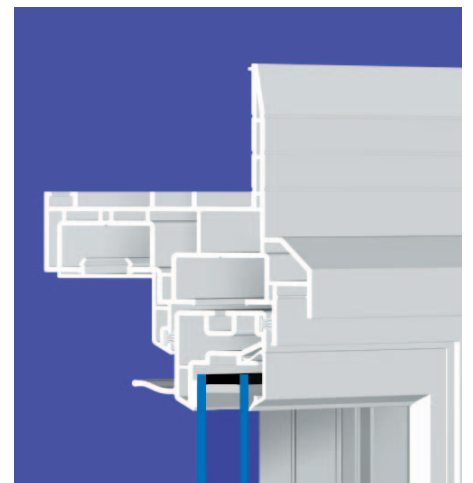

INTEGRAL RETRO FIN

Coronado series retro fin windows have an innovative twin-wall fin that eliminates extensive stucco repair or exterior trim and achieves a finished look you will enjoy for years to come.

locks Nearly
etration.
eries vinyl
files are made
ade titanium
lock more light
a built-in "sun
s light means
ion for your
d home.



Competitive vinyl salvaged from lesser quality windows that were replaced. Photo not altered.

Watch Out for Impostors

Anlin uses color-stabilized vinyl to prevent discoloration and keep your windows looking new. Vinyl windows of lesser quality may start out white but can end up looking dingy and discolored after normal exposure to the elements.



Our vinyl starts white and stays white.

Get Features and Optio

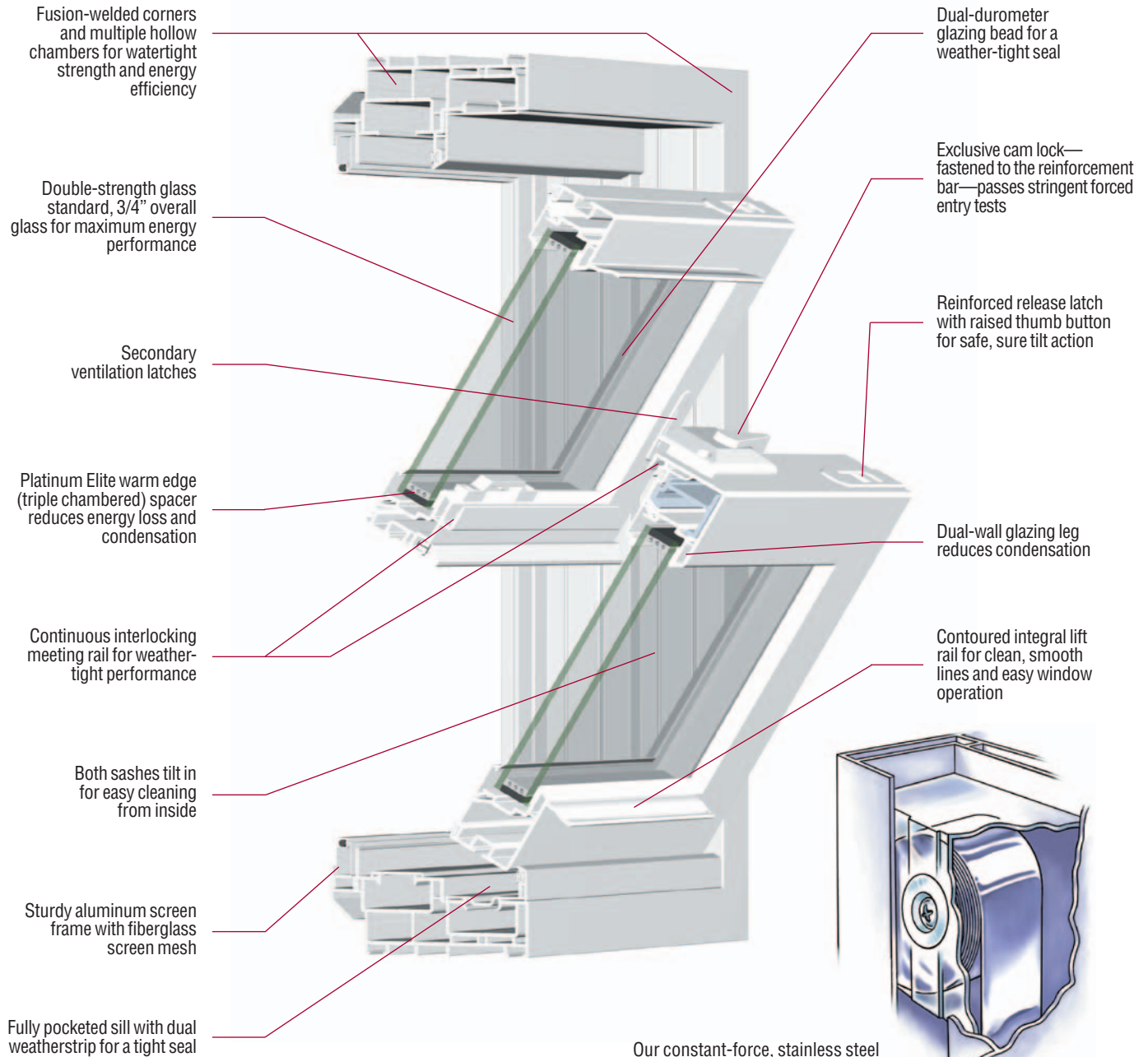

Our constant-force, stainless steel balance system is engineered for easy, smooth operation.

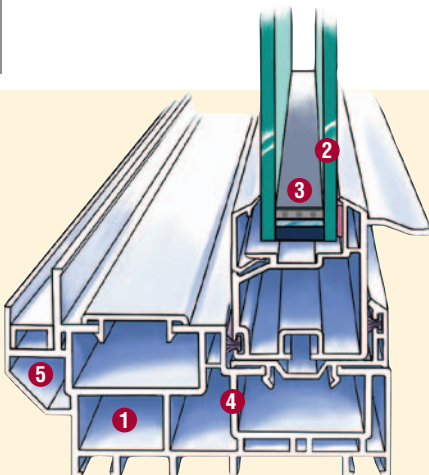

Advanced Design and Engineering is Standard

- 1) Multiple hollow chambers for strength and insulation.
- 2) Dual-pane insulated glass with double-strength glass.
- 3) Platinum Elite warm edge (triple chambered) technology for superior thermal performance and reduced condensation.
- 4) Thick vinyl walls for added structural integrity.
- 5) Built-in drainage to the exterior.

ns That Fit Your Needs

**NOW WITH
TRIPLE-LAYER,
HEAT REFLECTIVE
SILVER COATING**

INFINIT^e PLUSTM HIGH PERFORMANCE GLAZING SYSTEM

— FEATURING —

PLATINUM ELIT^e



Winter: Infinite Plus glass keeps the heat in.

INFINIT^e PLUSTM High Performance Glazing System combines a patented, triple-layer, heat reflective silver coating on the glass with the most technologically advanced window spacer available; Platinum Elite. Exclusive to Anlin Window Systems, this structural silicone foam spacer (triple chambered) contributes better insulation in our INFINIT^e PLUSTM High Performance Glazing

System. Combined, they better control sunlight's heat during the summer and provide more insulation to prevent heat loss during the winter for year round comfort and energy savings. "Plus," is our Easy-Clean smooth, durable solar activated coating on the outside glass surface to help keep your new windows cleaner longer, and be easier to clean.

Summer: Infinite Plus glass keeps the heat out.

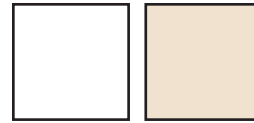

WHITE OR TAN COLORS

Coronado vinyl windows are available in two easy-to-clean colors: White or Tan. Both colors are integrated throughout the vinyl making scratches and scuffs harder to see.

NEW TWO-TONE BRONZE EXTERIOR ON WHITE INTERIOR

(Note: Only available on Coronado Casements and Awnings)

Our new dark Bronze color (exterior only), is a Solar Reflective Coating (SRC), a durable and specially formulated paint to reflect solar heat radiation. Optional Grids are two-tone in color also; Bronze facing outside and White facing in.

TOTAL WINDOW U-FACTOR

100% = Total Platinum Elite Efficiency

SPACER SYSTEM

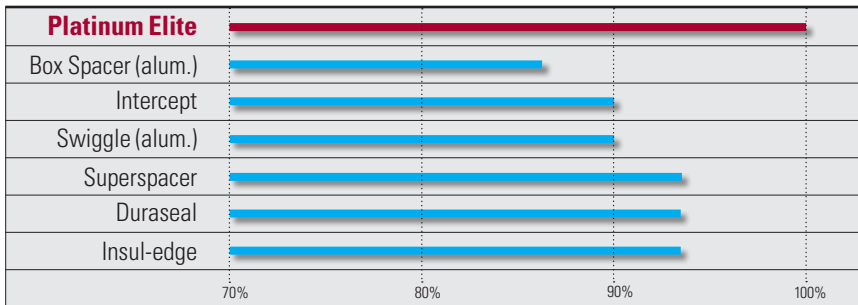

Numbers based on Anlin Catalina Series XO sliding window with Infinite-air/clear glass.

THREE DIFFERENT GRID STYLES

Coronado vinyl windows features three different grid styles: 5/8" wide Flat, 5/8" Sculptured, or 1" wide Euro. These metal grids are color matched, mitered at the intersections, and sealed inside the glass panes for easy window cleaning.

Choose the Window Configuration That's Right for You

Coronado series vinyl windows are available in many styles and configurations to enhance the beauty and appearance of your home.



DOUBLE-HUNG

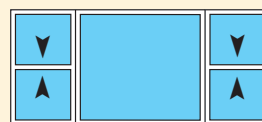

DH / PICTURE / DH

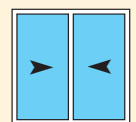

DOUBLE SLIDER



PICTURE WINDOW

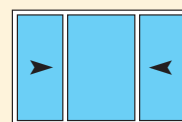

XOX SLIDER

THERMAL PERFORMANCE DATA

Coronado windows with **INFINIT@PLUS*** glass leads the industry in thermal performance.

Window Style	UV Block ¹	Visible Light Transmittance ²	Total Unit U-Factor ³	Solar Heat Gain Coeff. ⁴
Double-Hung (Standard Double-Pane Clear)	42%	82%	0.46	0.59
Double-Hung (INFINIT@PLUS*)	95%	66%	0.32	0.21
Double-Hung (INFINIT@PLUS* with Argon)	95%	66%	0.28	0.21
Double-Slider (Standard Double-Pane Clear)	42%	82%	0.45	0.60
Double-Slider (INFINIT@PLUS*)	95%	66%	0.31	0.21
Double-Slider (INFINIT@PLUS* with Argon)	95%	66%	0.27	0.21
Picture Window (Standard Double-Pane Clear)	42%	82%	0.46	0.67
Picture Window (INFINIT@PLUS*)	95%	66%	0.30	0.24
Picture Window (INFINIT@PLUS* with Argon)	95%	66%	0.26	0.24

¹ Ultraviolet (UV) light block calculations performed using Lawrence Berkeley Laboratories Window 4.1 program. Percentages indicate amount of UV transmittance blocked from the interior using a 3/4" glazing unit.

² Visible light transmittance indicates the amount of outside light reaching the interior as calculated using center of glass. Higher percentages mean more outside light reaches interior.

³ U-factor represents the amount of heat transfer as measured in accordance with NFRC 100-2001, calculation uses total window unit, and assumes 3/4" glazing with a 1/2" airspace. Lower is better.

⁴ Solar heat gain coefficient (SHGC) measures the amount of solar radiation entering the building. As measured per NFRC 200-2001 with the Window 4.1 and Frame 4.1 modeling programs. Lower is better.

CERTIFIED TO MEET OR EXCEED EXPECTATIONS

All Anlin windows are AAMA and NFRC certified, and ENERGY STAR® qualified with:



INSTALLATION STANDARDS

Anlin Window Systems' recommends following installation standards in your local building codes, and the instructions found in the following AAMA publications:

Replacement: AAMA 2410-03: Standard for Installation of Windows with an Exterior Flush Fin Over an Existing Window Frame.

Replacement: CAWM 420-97: Standard for Installation of Block Frame Windows Utilizing an Existing Perimeter Wood Frame.

New Construction: AAMA 2400-02: Standard for Installation of Windows with a Mounting Flange in Stud Frame Construction.

OUR MANUFACTURING PLANT

Anlin Window Systems' advanced technology manufacturing plant is located in central California.



Your Authorized Anlin Window Systems Dealer: